

- NOTES:
- POURED IN PLACE (PIP) RUBBER SURFACING TO BE "GTIMPAX" OR APPROVED EQUAL.
 - GRANULE SIZE TO BE 1-4 MM.
 - GRANULES TO BE EPDM.
 - BINDER TO BE AROMATIC TYPE.
 - REFERENCE SPECIFICATION SECTION 32 1816.13

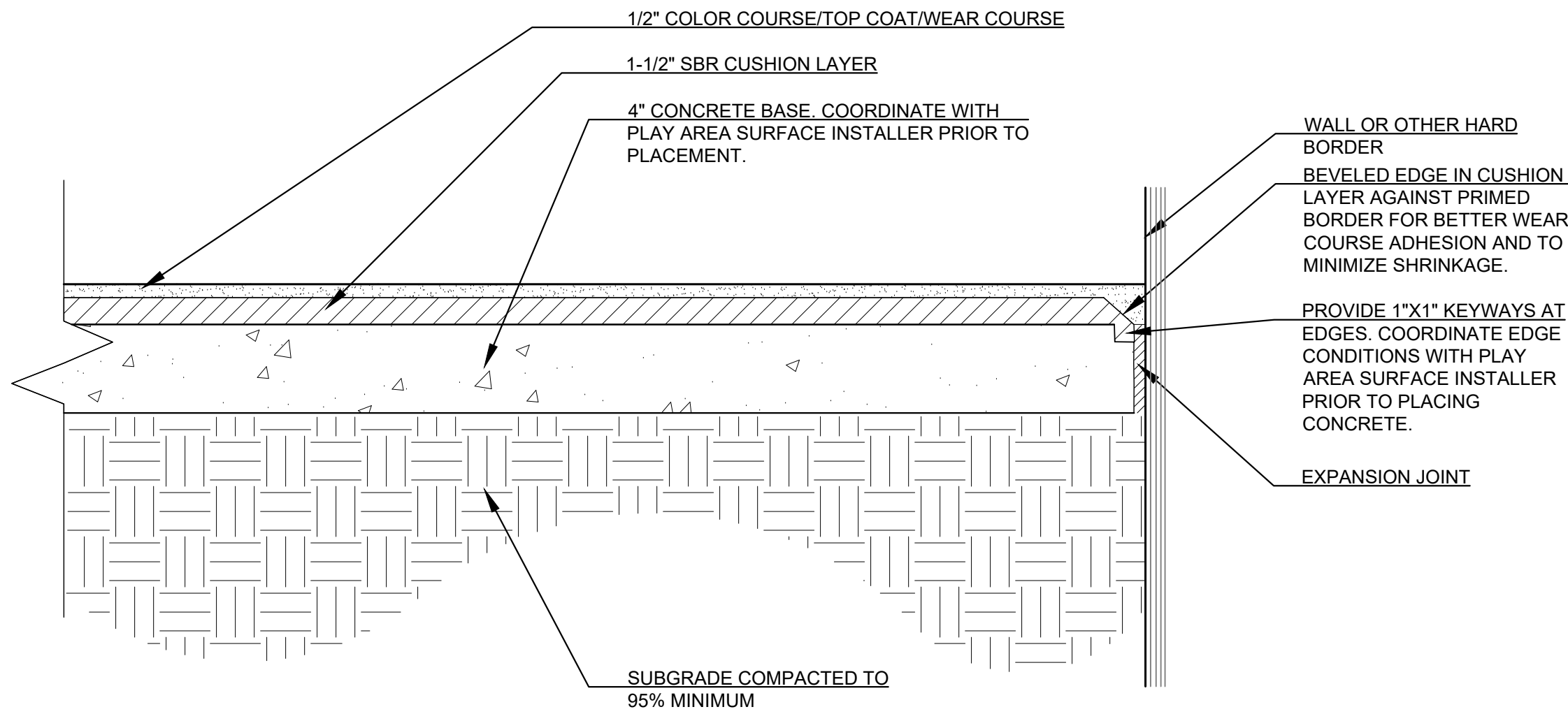

1
L102
POURED IN PLACE RUBBER DETAILS
NOT TO SCALE

2
L102
NOT USED
NOT TO SCALE

3
L102
NOT USED
NOT TO SCALE



- NOTES:
- ALL AREAS TO BE SLOPED TO DRAIN AT 1% MINIMUM.
 - ALL ELEVATIONS ARE TO TOP OF FINISHED SURFACE, INCLUDING POURED IN PLACE RUBBER SURFACE WHERE APPLICABLE. SURFACE OF BASE MATERIAL MUST BE SET TO ALLOW FOR THICKNESS OF RUBBER SURFACING MATERIALS.
 - ALL COLORS AS PER GTIMPAX POURED EPDM:
 - BLUE, STANDARD BLUE WITH 25% BLACK.
 - GREEN, STANDARD GREEN WITH NO BLACK.
 - DARK GREEN, STANDARD GREEN WITH 50% BLACK.
 - BEIGE, STANDARD BEIGE WITH NO BLACK.
 - TERRA COTTA RED, STANDARD TERRA COTTA RED WITH NO BLACK.

4
L102
POURED IN PLACE RUBBER SURFACE PLAN
1" = 10'

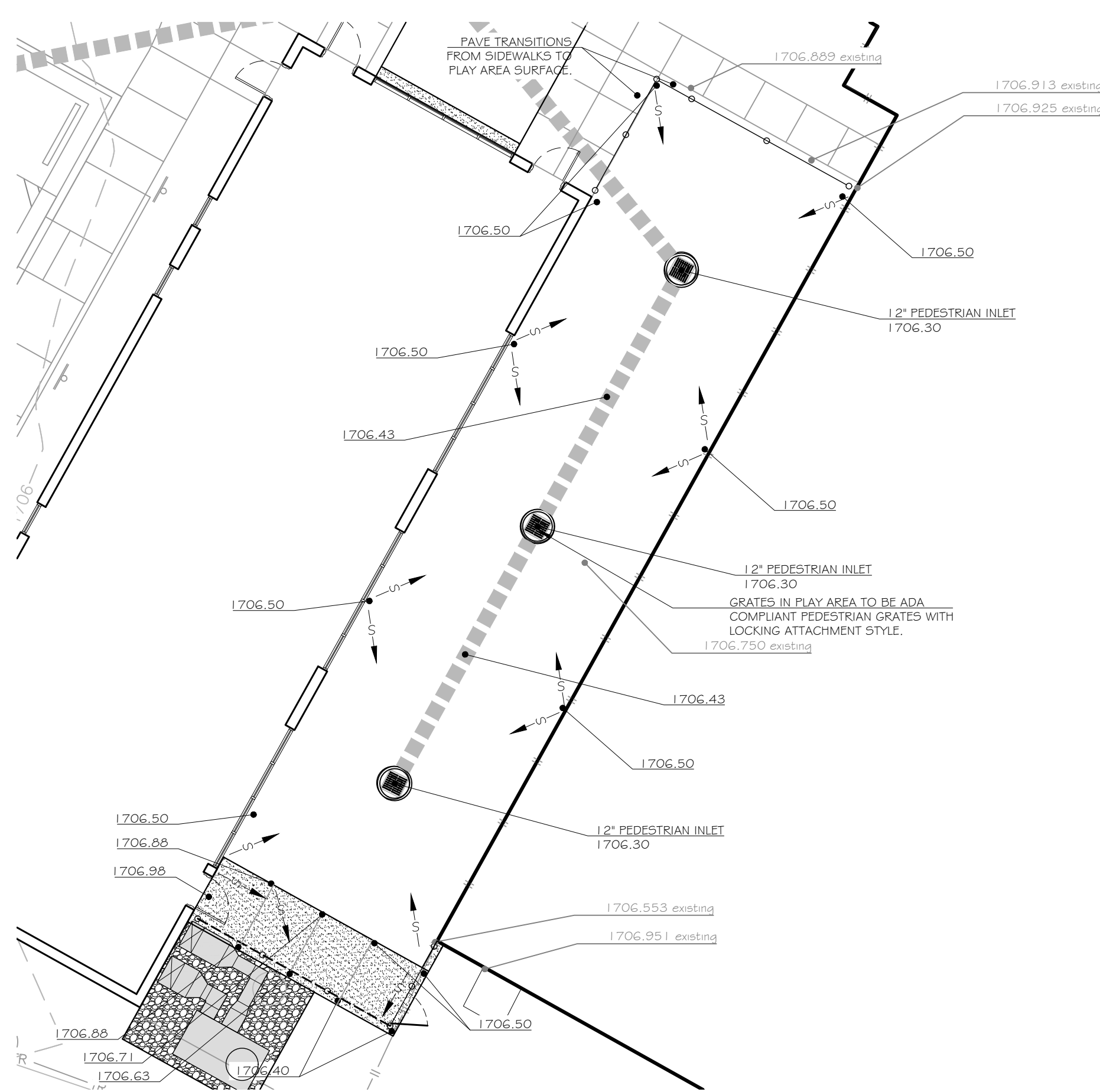

- NOTES:
- ALL AREAS TO BE SLOPED TO DRAIN AT 1% MINIMUM.
 - ALL ELEVATIONS ARE TO TOP OF FINISHED SURFACE, INCLUDING POURED IN PLACE RUBBER SURFACE WHERE APPLICABLE. SURFACE OF BASE MATERIAL MUST BE SET TO ALLOW FOR THICKNESS OF RUBBER SURFACING MATERIALS.

5
L102
PLAY AREA GRADING DETAIL
1" = 10'

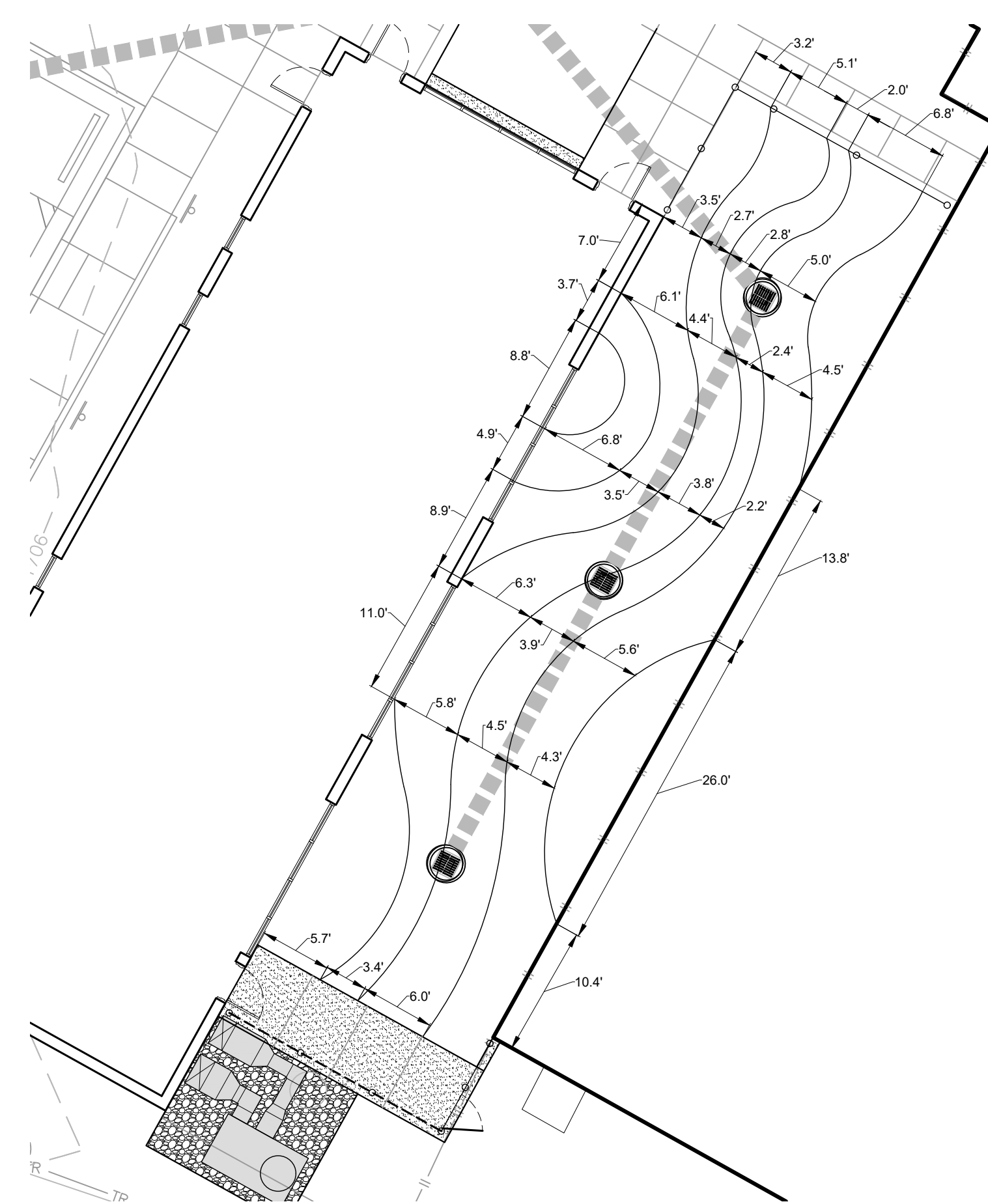

- NOTES:
- ALL DIMENSIONS ARE IN DECIMAL FEET, NOT FEET AND INCHES.
 - ALL CURVES SHALL BE SMOOTH AND CONSISTENT. THERE ARE NO STRAIGHT LINES.
 - CONTRACTOR MAY CALL LANDSCAPE ARCHITECT FOR A FIELD CONFIRMATION OF LAYOUT PRIOR TO TOP LAYER BEING PLACED. PROVIDE A MINIMUM OF ONE WEEK NOTICE.

6
L102
PLAY AREA LAYOUT
1" = 10'

BIOME Projects
Landscape Architecture
Decatur and Suches
Georgia
(404) 455-5578
www.biomeprojects.com

PRAXIS3

100 Peachtree St NW
Suite 1450
Atlanta, GA 30303
404-875-4500 tel
www.praxis3.com



Copyright (c) 2025 Praxis3, LLC
All reports, plans, specifications, computer files, field data, notes and other documents and instruments prepared by Praxis3 shall retain all copyright law, statutory and other reserved rights, including copyright therein.
This drawing may not be reproduced in whole or in part without written permission of Praxis3. It is to be returned upon request. Stamps as stated are valid on this original drawing.

Rev	Date	Comments
	05/22/26	PERMIT & BID

Client:
Fannin County

370 Tom Boyd Road
Blue Ridge, Georgia 30513

Project Number: 24184
Project Name:

**Fannin County
Rec Center
Phase I**

580 Winding Drive
Blue Ridge, Georgia 30513

Key Plan:

Sheet Title:
**PLAY AREA
DETAILS**

Sheet Number:

L-102-I